

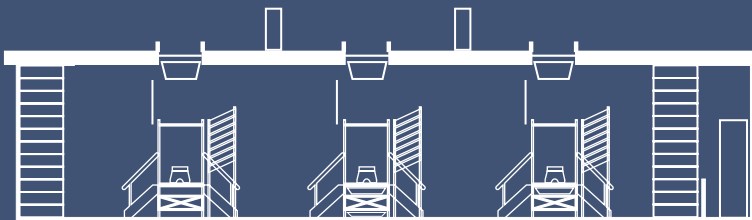

Typical 3-Bay Lube Facility

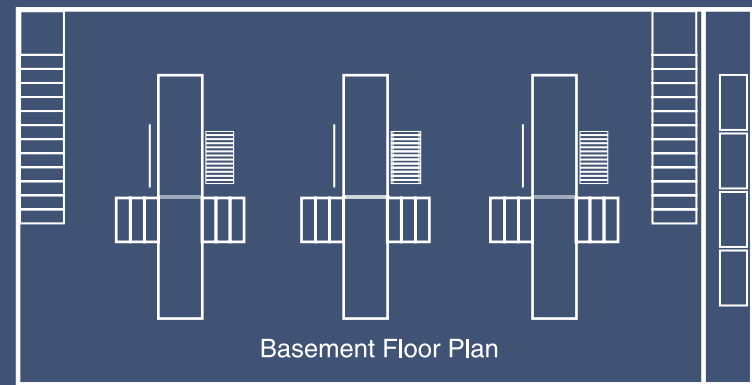

Call for Custom Design Service

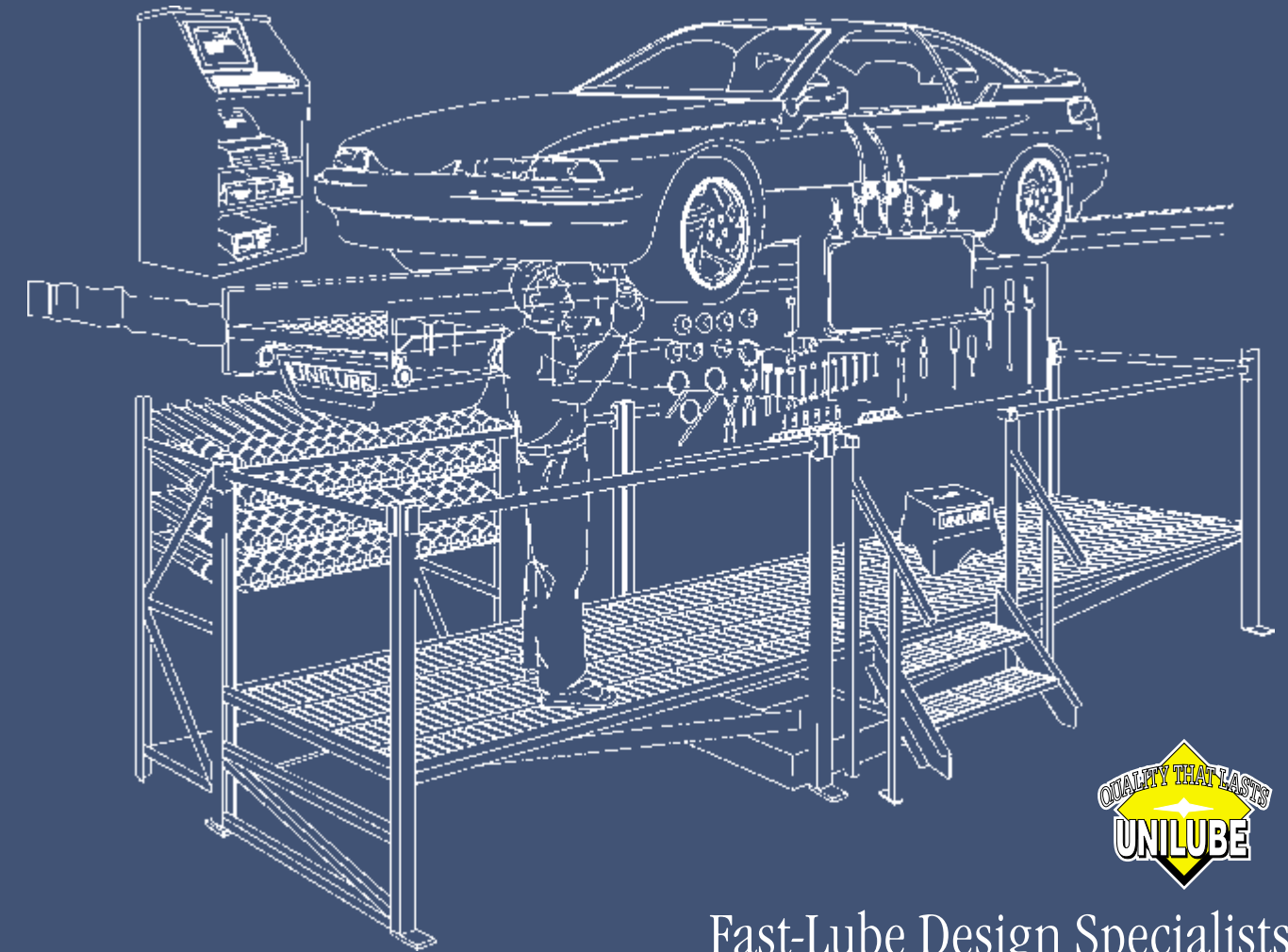

Fast-Lube Design Specialists

For Your Nearest Distributor Call 1-800-326-1711

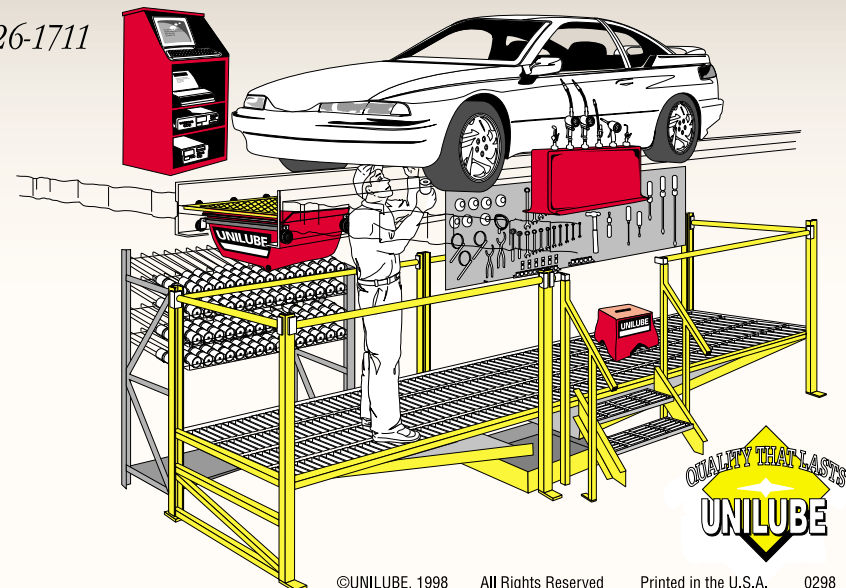

The **UNILUBE** System of modular components quickly and easily assembles into a sturdy long-lasting technicians work system. The components shown in this catalog provide for a highly efficient and fully functional quick-lube operation that is un-surpassed in quality, safety and value.

QUALITY COMMITMENT

As a specialty equipment leader of the quick lube industry, we are the company of choice in providing safe, reliable, easily assembled and long lasting products. Our products improve working conditions, efficiency and deliver long-term value. We back our quality with a warranty.

SAFETY COMMITMENT

Beginning with Pit Guard™, the premier pit covering system, all Unilube products have been designed with safety as our number one priority. All products meet or exceed OSHA and Uniform Building Code requirements. All products are carefully engineered and tested for safe operations and long lasting service.

VALUE ADDED

All Unilube products are designed to maximize speed, safety, and productivity. All service related items are within easy reach of the technician. The snap together modular construction method utilized allows a complete two bay installation in under 8 hours with no specialized labor required for construction. Speed of installation and maximum performance are attributes that deliver extra value to our customers.

WARRANTY

Unilube products are warranted against defects in material and workmanship for a period of one year when used in accordance with manufacturer's specifications and/or operating instructions. Excluded are normal wear and tear, misuse or abuse of product. This warranty applies to the original purchaser only. A purchaser's sole remedy under this warranty is limited to replacement or repair of the product at Unilube's discretion and specifically excludes consequential, incidental, or any other damages directly or indirectly resulting from failure or loss of use of or by Unilube products.*

** Unilube extends the time warranty for the following units:*

Work Platforms with fiberglass decking	3 years
Work Platform Stairs with fiberglass decking	3 years
Pit Guard™	5 years
Fiberglass replacement decking for Work Platforms	3 years

UNILUBE™ SYSTEM

- Meets OSHA and Uniform Building Code Requirements.
- Powder Coated Steel for Maximum Durability.
- Modular Components for Quick Assembly.



OIL FILTER RACK

- OFR-4+1 — Holds Over 500 Oil Filters.
- Powder Coated Steel for Maximum Durability.
- Quick 15 Minute Assembly.

SNAP/LOCKS

- Tool-Free Assembly.
- Spring Clips Lock the Components Together.
- Fast Installation.
- Flexible Configuration.



STAIRS UNIT

- STA-FG — Included in the System as Shown.
- Also Available Separately.
- Fiberglass or Metal Risers
- Powder Coated Steel for Maximum Durability.

STEP STOOL

- FS-12 — Rugged Fiberglass Construction.
- Gritted Non-Slip Top Surface.
- Wide-Angle No-Tip Base.

WORK PLATFORM

- WP17-FG — Fiberglass Decking.
 - WP17-M — Metal Decking.
- Platform Shown with Available Options*



SAFETY DECKING

- Choose from 2 Types:
- Fiberglass Floor Decking.
- Galvanized Metal Decking.

TOOL BOARD

- TB-ABC-T — Holds 67 Tools at Convenient Reach.
- Designed Especially for the Fast-Lube Shop.



PIT GUARDS™

- Industry Leader in Protection for Workers and Customers.
- Meets OSHA Requirements for Open Pits.
- Meets Insurance and Local Government Safety Regulations.
- Pit Guards™ are Built to Withstand Weights in Excess of One Ton.
- Easy to Install.
- Can Be Installed with Regular Angle Iron.
- Our Combination Track, which is welded to the pit wall, serves Triple Duty as Tire Guide, Pit Guard™ Track and Rolling Drain Pan Track.
- **WHAT'S GROSS NEGLIGENCE?** Ask Your Lawyer. If You are Operating with Open Pits, That's One Definition.

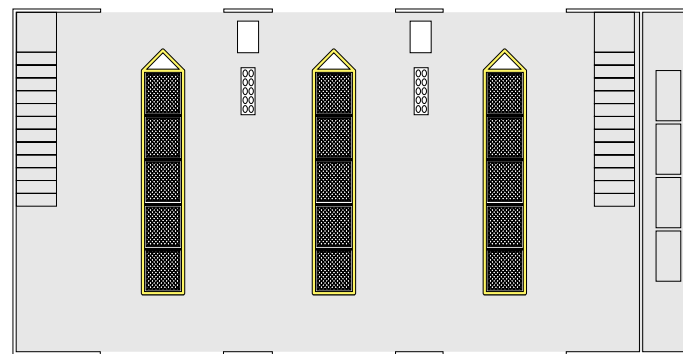

TYPICAL 3-BAY FLOOR PLAN with Pit Guards™



CS-1

COMPUTER WORK STATION

- Durable 14 Gauge Steel Construction.
- Chemical Resistant Powder Coat Finish.
- Adjustable Padded Feet and Black Rubber Shelf Lining.
- Cabinet Top Adds Protection and Doubles as a Handy Writing Surface.
- Storage Shelves for Printer, CPU, Printer Paper and Supplies.
- Dimensions: 23" W X 28" D X 48" H.

LUBE CONSOLE

- 10-Station Dispensing Shown.
- Available in 6, 8, 10 Dispensing Stations.
- No Need for Expensive Hose Reels.
- Graphite/Polymer Hose Rings Cut Down on Hose Wear.
- Doubles as a Space Saving Work Station.
- Speeds Up Service (No Tugging On a Stubborn Hose Reel).
- Great for Retrofitting Existing Fast Lube Locations.
- In-Line Lube Console Available.

LC-10

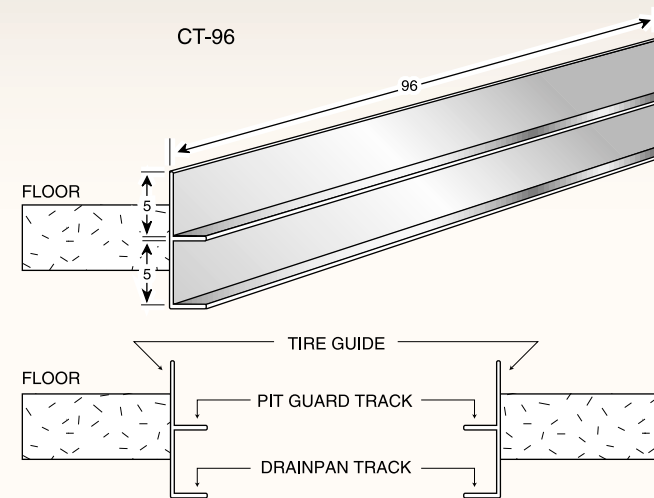

COMBINATION TRACK

- Serves 3 Purposes:
 - Tire or Toe Guide,
 - Track for Pit Guard™ Panels,
 - Track for Rolling Drain Pan.
- Red Oxide Coating.
- Dimensions: 10" x 2" x 96" Sections.
- Ideal for New Installations or Retrofitting.

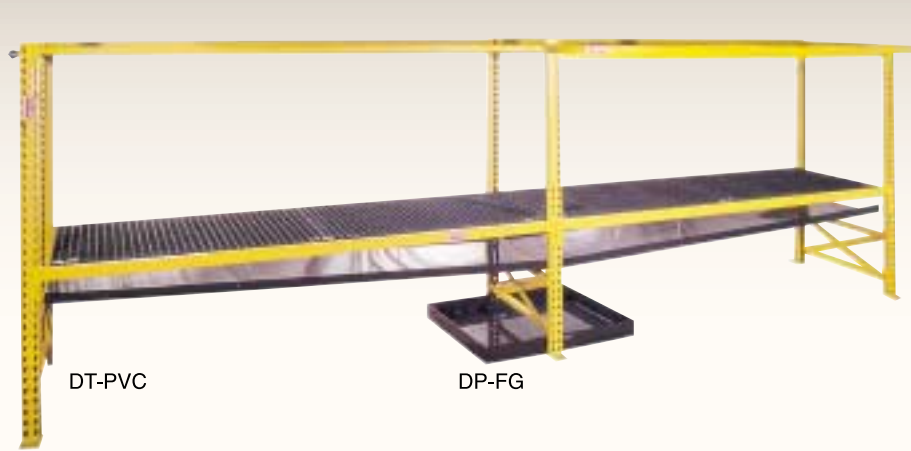

DT-PVC

DP-FG



S-60X18-4PB

DRIP TRAY AND PAN

- PVC and Fiberglass Construction.
- Fire Resistant.
- Impervious to Oil and Chemicals.
- Will Not Rust or Chip.
- Keeps Oil, Water and Debris in Contained Area.
- Prevents Slips and Ecological Hazards.
- Easy to Install.

STEEL SHELVING

- Heavy-Duty Grade Shelving.
- Easy To Assemble.
- "Boltless" Rivet-to-Eye Design.
- No Special Tools Needed.
- Powder Coated Finish (16 Times Harder Than Paint).
- Various Lengths and Widths Available.
- Particle Board or PVC Shelves Available.

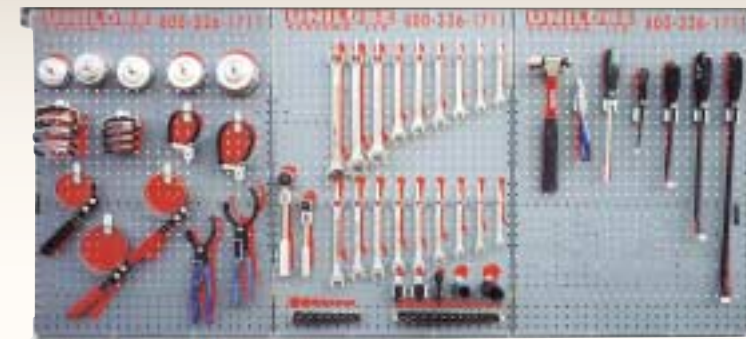

TB-ABC-T

TOOL BOARD

- Designed Especially for the Fast Lube Shop.
- Holds 67 Tools Total Including:
- 12 Filter Wrenches ■ 2 Filter Pliers.
- Set American Standard Wrenches & Sockets.
- Set Metric Wrenches & Sockets.
- Ball Peen Hammer ■ Pry Bars.
- Ratchets & Adapters.
- Lifetime Warranty (Except Impact & Torque Wrenches).
- Galvanized Frame Holds Super-Tough, Heavy Duty Molded Pegboard with Fittings in Place.



OFR-4+1

OIL FILTER RACK

- 15 Minutes Required to Assemble.
- Provides Filters at the Technician's Finger Tips.
- High Volume — Holds Over 500 Filters.
- All Steel Construction.
- Powder Coated Paint for a Lifetime of Service. (16 Times Harder Than Normal Paint).



AFR-1

AIR FILTER RACK

- Holds Up To 144 Filters.
- Designed for Easy Access from Either Side.
- 4 Shelves Designed Especially for Air Filters.
- Durable 14 Gauge Steel Construction.
- Adjustable Padded Feet.



FS-12

STEP STOOL

- Rugged Fiberglass Construction.
- Gritted Non-Slip Top Surface.
- Wide-Angle No-Tip Base.
- Large Skid-Free Rubber Padded Feet.
- High Visibility Red Color.
- Convenient Carry Handle.



RDP-M

METAL ROLLING DRAIN PAN

- 14 Gauge Steel.
- Adjustable to Fit Pits 32" to 48" Wide.
- 3 Variable Height Adjustments.
- Low Noise Ball Bearing Rollers.
- 34 Gallon Capacity.
- Anti-Splash Grill.
- Front & Rear Drain Connections.
- Utility Tool Shelf.



RDP-FG

FIBERGLASS ROLLING DRAIN PAN

- Rugged Fiberglass Construction.
- Adjustable to Fit Pits 32" to 48" Wide.
- No Sharp Edges.
- Interior Baffles to Prevent Sloshing.
- 40 Gallon Capacity.
- Front and Rear Drain Connections.
- Three Choices for Wheel Height.
- 3" Diameter Low-Noise Ball Bearing Rollers.